

THIS DOCUMENT MUST NOT BE COPIED WITHOUT OUR WRITTEN PERMISSION, AND THE CONTENTS THEREOF MUST NOT BE REPRODUCED, EITHER WHOLLY OR PARTIALLY, IN ANY MANNER, WITHOUT OUR WRITTEN PERMISSION. THIS DOCUMENT IS INTENDED FOR INFORMATIONAL PURPOSES ONLY. CONTRAVENTION WILL BE PROSECUTED.

REVISIONS			
REV.	DESCRIPTION	DATE	SIGNATURE
A	FOR MANUFACTURING	2009-03-31	TF
B	ADDED CAPTURE PLATE	2017-09-05	JA
C	UPDATED FITTING PLATES	2023-09-26	PB

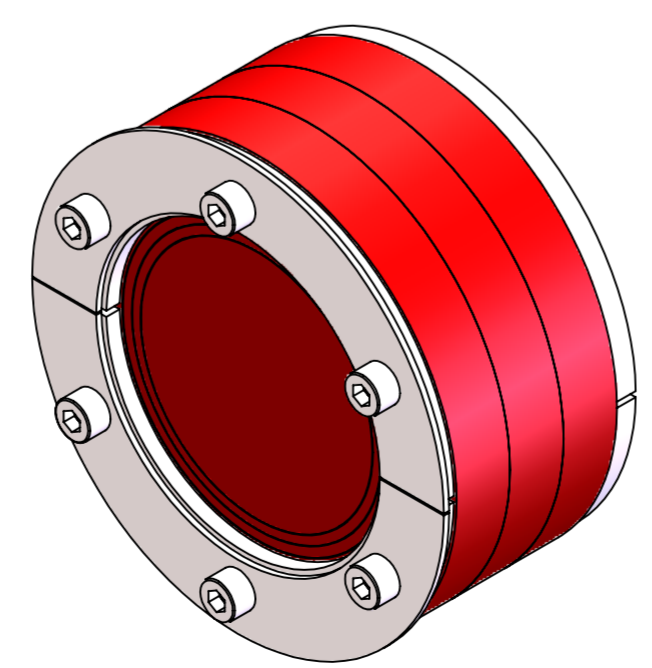
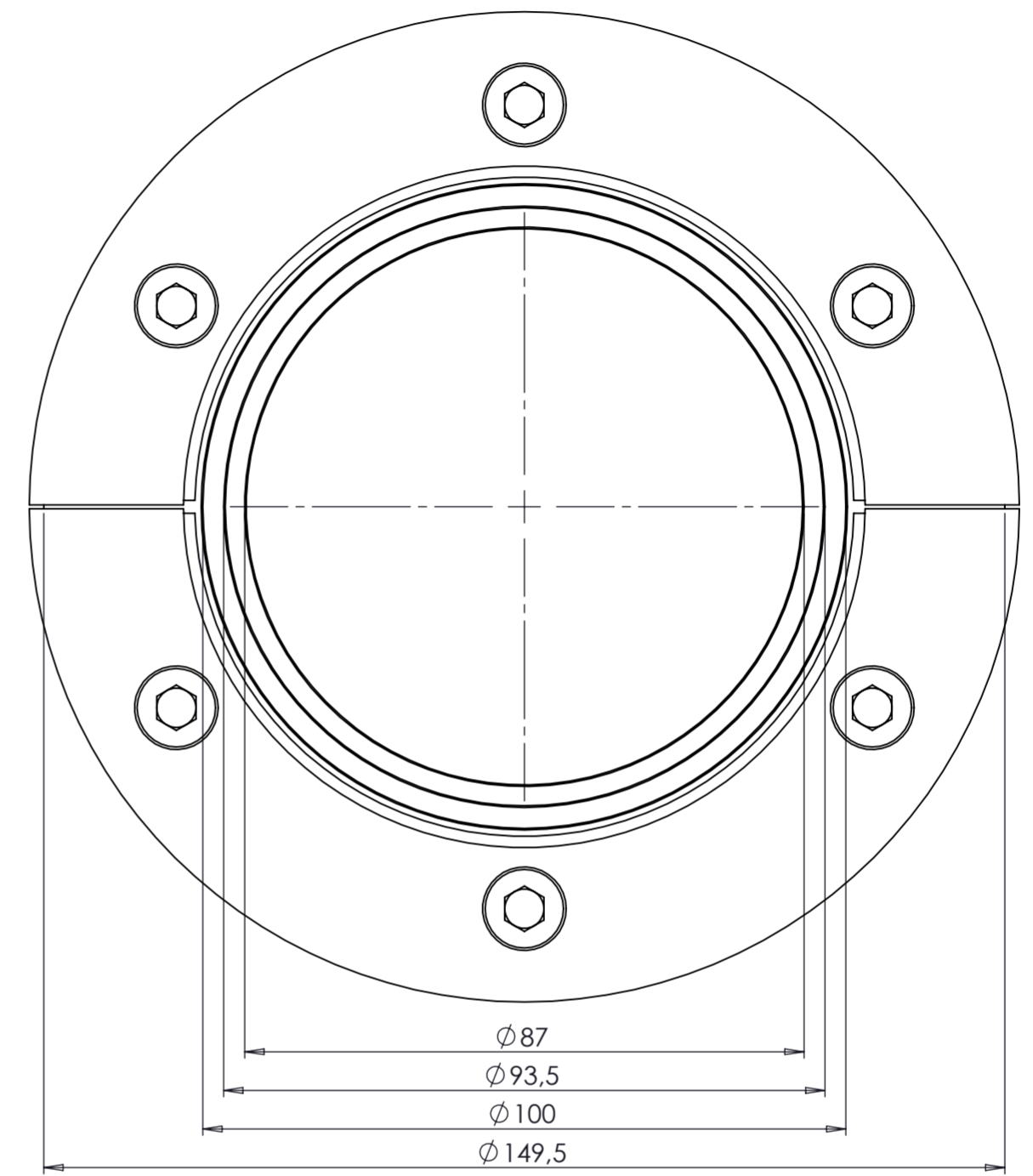
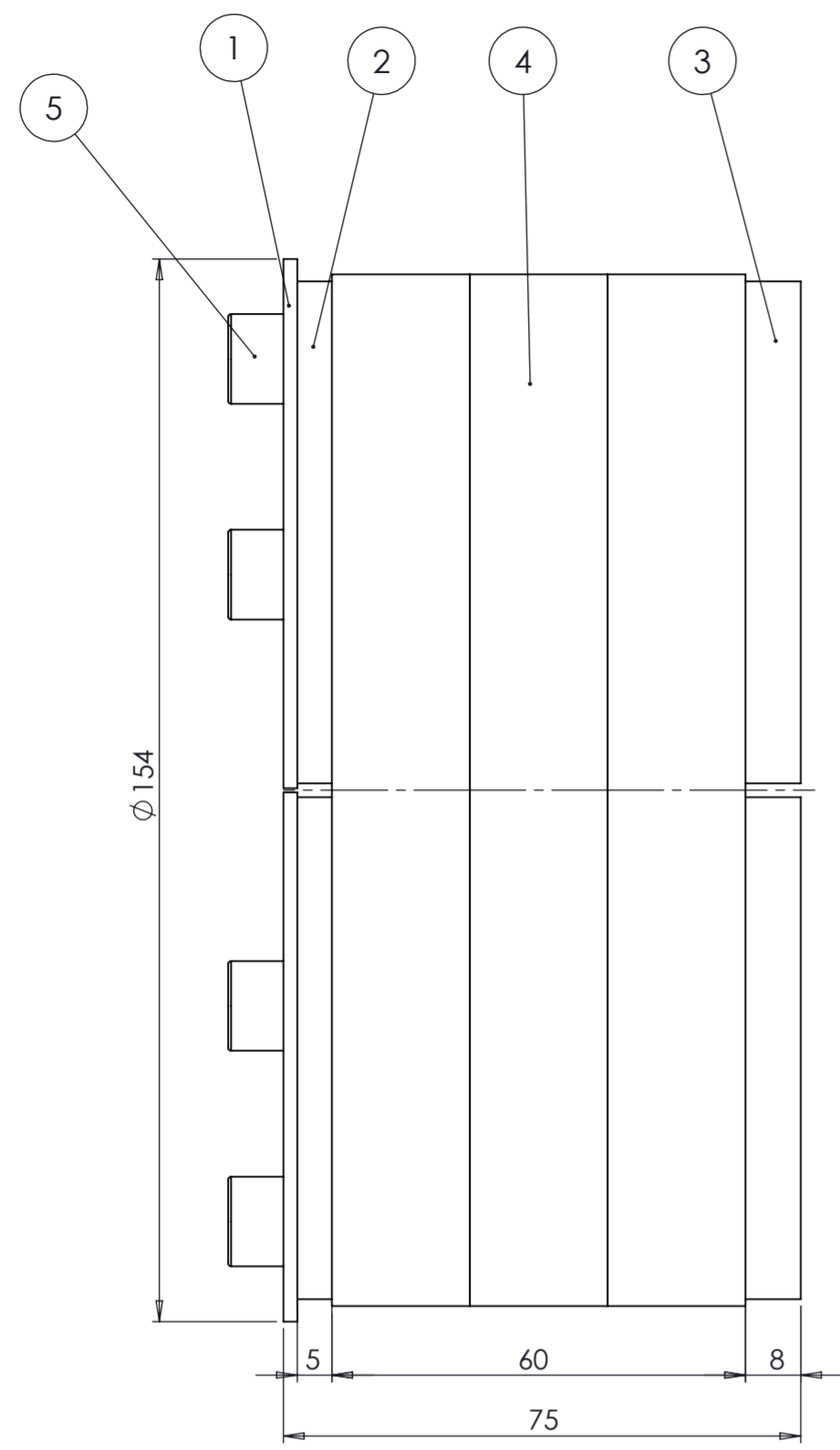

ITEM NO.	TITLE	DRAW. No. / DESCRIPTION / MATERIAL	QTY.
1	CAPTURE PLATE	1230290 / 2mm / 316L	1
2	FRONT PLATE	1230290 / 5mm / 316L	2
3	BACK PLATE	1230290 / 8mm / 316L	2
4	RUBBER SEAL	1100868	1
5	SCREW	ISO 4762 - M8 x 70	6

Ritad. Drawn	Kontr. Check	Granskad. Reviewed	Godkänd. Approved	Tolerans där ej annat anges Tolerance unless otherwise stated.	Smst. nr. Assembly drawing no.	Ersätter Replaces	E
B0	PB	LS	AK	Ytjämnhet där ej annat anges Surface finish otherwise stated.		Ersatt av Replaced of	Vikt Weight 2,7 Kg
090326	230926	230927	230927			Alla mått och uppgifter avser färdig produkt om ej annat anges All measures and other information refer to finished products unless otherwise stated.	
SR-150						Kund ordernr. Customer order no.	
MCT BRATTBERG						Ritn. nr. Draw no.	Rev.
						1090117	C